

CHRIS VAN UFFELEN

CONCRETE CONCRETE CONCRETE

PURE. STRONG. SURPRISING.

BRAUN

MUMBAI, INDIA HOUSE ON A STREAM

ARCHITECTS: ARCHITECTURE BRIO_ **COMPLETION:** 2013_ **GROSS FLOOR AREA:** 300 M²_ **TYPE OF CONCRETE:** IN-SITU CONCRETE_ **FUNCTION:** LIVING_ **PHOTOS:** SEBASTIAN ZACHARIAH

With a stream running through the house, this retreat in Alibag is delicately woven into the landscape. The house reaches out into the landscape, making full use of the views within the site and dramatizing special features. The house comprises two parts: the social areas, such as the dining room, kitchen, living room and entrance verandah. The orientation of the program is based on climatic considerations. The bedrooms are mostly west-facing with large verandahs that soak up the evening sun. The external concrete shell responds to the site and its orientation and flows from high to low in accordance with the monolithic fluidity of the form. A series of asymmetrical axes create a path of discovery through the house.

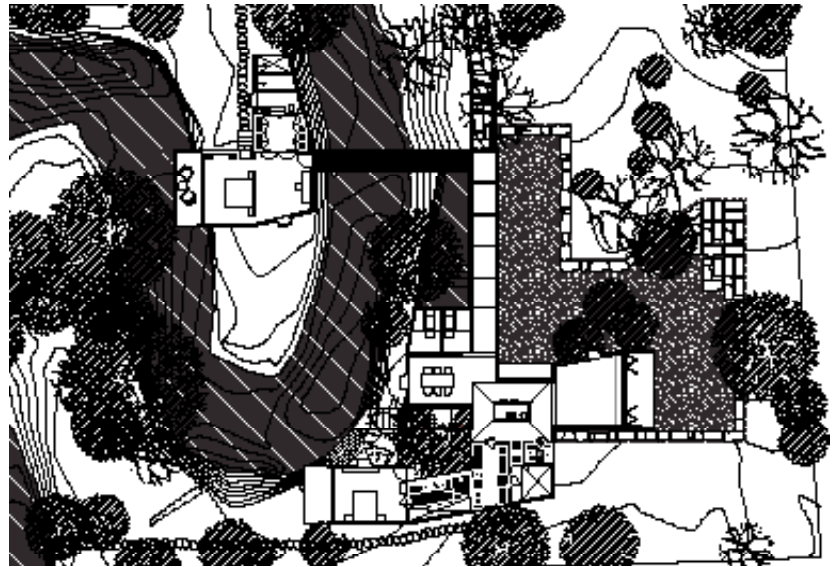

left: Ground floor and site plan_Pool_Guestroom. right: Exterior view_Kitchen_View from kitchen into living room.







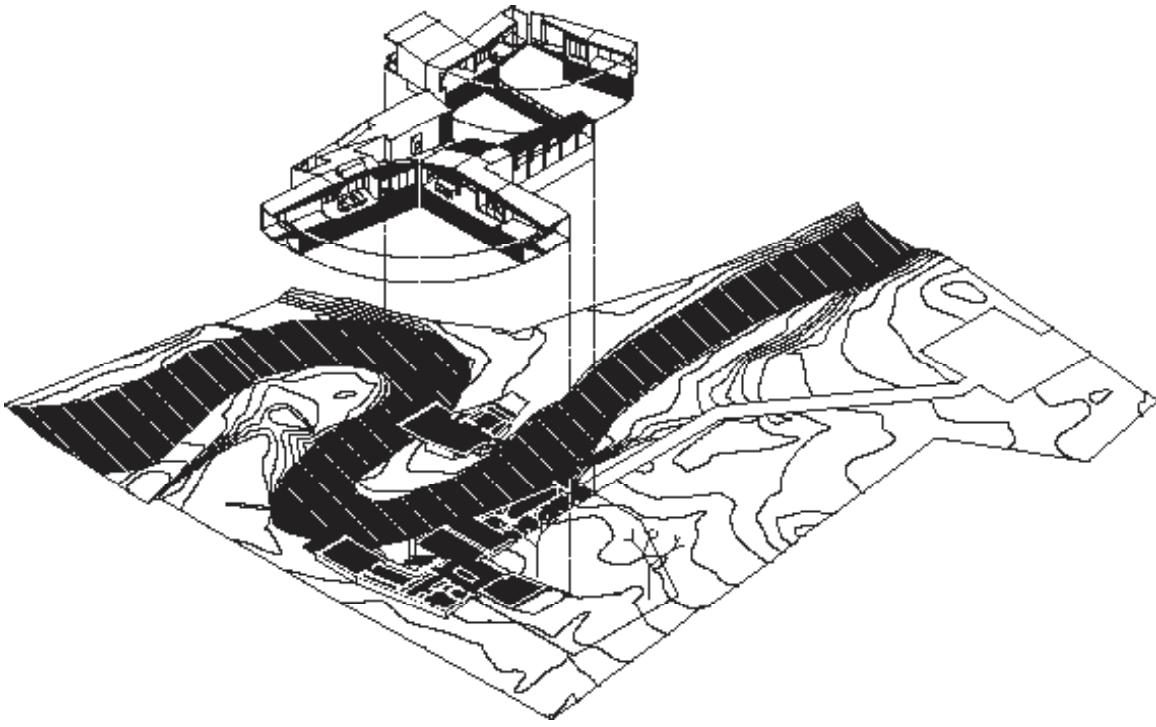

left: Guest bathroom. right: Exploded view_Dining room and semi-enclosed courtyard.

